

# HIGH PERFORMANCE VALVES FOR BUILDING SERVICE APPLICATION



**YUTA®**

16 BAR GATE VALVE W.O.G

Rising Stem, OS&Y

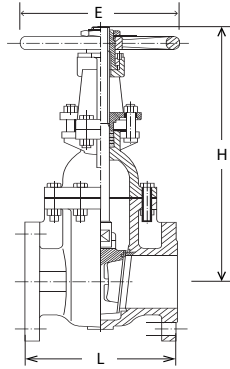

Fig. 125CG

• Size : 2" - 12"

MATERIALS

PART	MATERIAL
Body	Cast Iron
Bonnet	Cast Iron
Disc	Cast Iron
Stem	Stainless Steel
Seat Ring	Stainless Steel
Handwheel	Cast Iron

Valve Size	inch	2	2½	3	4	5	6	8	10	12
	mm	50	65	80	100	125	150	200	250	300
L Face-to-face		215.9	241.3	282.5	304.8	381	403.2	419.1	457	502
H Height (OPEN)		385	437	493	611	716	813	1023.5	1211	1386
E Handwheel Diameter		180	180	180	260	260	280	360	360	450

- Maximum Working Pressure : 16 Bar
- End Flange Connection : ANSI 125
- >12" by Request

16 BAR SWING CHECK VALVE W.O.G

Swing Type, Bolted Cover

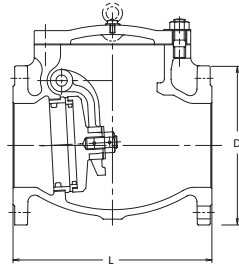

Fig. 125CC

• Size : 2" - 12"

MATERIALS

PART	MATERIAL
Body	Cast Iron
Cover	Cast Iron
Disc	Cast Iron
Seat Ring	Brass

Valve Size	inch	2	2½	3	4	5	6	8	10	12
	mm	50	65	80	100	125	150	200	250	300
L		203.2	215.9	241.3	292.1	338.2	355.6	495.3	622.3	698.5
D		152.4	177.8	190.5	228.6	254	279.4	342.5	405.4	482.6

- Maximum Working Pressure : 16 Bar
- End Flange Connection : ANSI 125
- >12" by Request

16 BAR Y-PATTERN STRAINER W.O.G

Bolted Cover

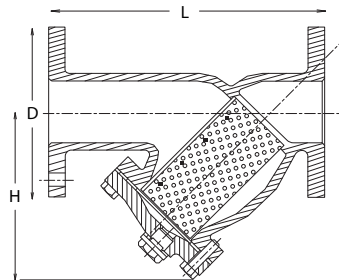

Fig. 125CY

Fig. 125DY

• Size : 2" - 6"

• Size : 8" - 10"

MATERIALS

PART	MATERIAL
Body	125CY: Cast Iron / 125DY: Ductile Iron
Cover	125CY: Cast Iron / 125DY: Ductile Iron
Screen	Stainless Steel

- Maximum Working Pressure : 16 Bar
- End Flange Connection : ANSI 125
- >10" by Request

Valve Size	inch	2	2½	3	4	5	6	8	10
	mm	50	65	80	100	125	150	200	250
L		250	285	315	370	420	490	570	680
D		152	178	191	229	254	279	343	406
H		154	173	195	225	268	328	425	497



## YUTA CAST & DUCTILE IRON VALVES

## ANSI & JIS CONNECTION

### 16 BAR GLOBE VALVE W.O.G

Rising Stem, OS&Y

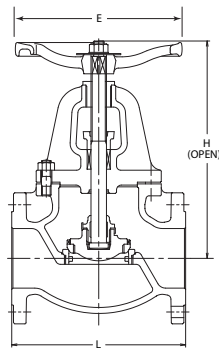

**Fig. 125CO**

• Size : 2" - 10"

Valve Size	inch	2	2½	3	4	5	6	8	10
	mm	50	65	80	100	125	150	200	250
L Face-to-face		203	216	241	292	330	356	495	622
H Height (OPEN)		248.8	262.5	289.4	351.6	405	426.5	554.5	627.5
E Handwheel Diameter		180	180	180	250	250	300	360	400

## MATERIALS

PART	MATERIAL
Body	Cast Iron
Bonnet	Cast Iron
Disc	Cast Iron
Stem	Stainless Steel 420
Seat Ring	Brass
Handwheel	Cast Iron

\* Maximum Working Pressure : 16 Bar

\* End Flange Connection : ANSI 125

\* >10" by Request

### 14 BAR BALL VALVE W.O.G

Two Piece Body, Lever Operated

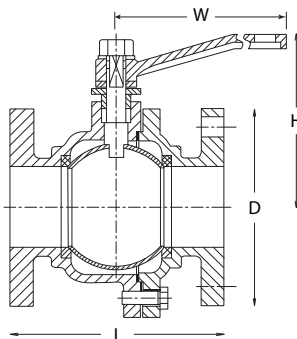
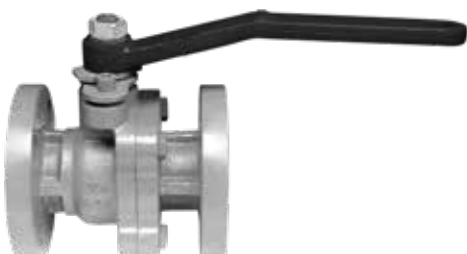

**Fig. 10CB**

• Size : 2" - 8"

Valve Size	inch	2	2½	3	4	5	6	8
	mm	50	65	80	100	125	150	200
L		165	180	190	200	230	265	277
D		140	155	175	185	210	250	280
H		260	286	306	331	388	414	484
W		271	271	271	271	310	373	475

## MATERIALS

PART	MATERIAL
Body	Cast Iron
Cap	Cast Iron
Ball	Stainless Steel
Seat	PTFE
Stem	Stainless Steel
Handle	Ductile Iron

\* Maximum Working Pressure : 14 Bar

\* End Flange Connection : JIS 10K

\* >8" by Request



**YUTA CAST & DUCTILE IRON VALVES**

**UNIVERSAL CONNECTION**

**16 BAR BUTTERFLY VALVES**

Wafer Type



**Fig. PN16CUG**

• Gear Operated:  
1½" - 24"



**Fig. PN16CUL**

• Lever Operated:  
1½" - 24"

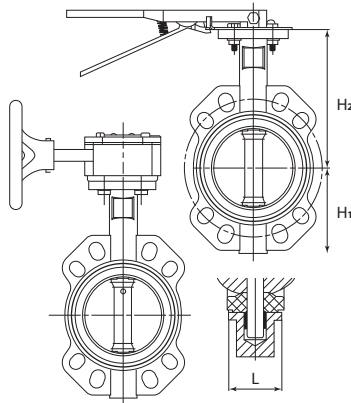

**MATERIALS**

PART	MATERIAL
Body	Cast Iron
Stem	Stainless Steel 420
Disc	Ductile Iron + Ni Plating
Seat	NBR
Bushing	PTFE
O Ring	NBR
Pin	Stainless Steel 410

Valve Size	inch	1½	2	2½	3	4	5	6	8	10	12	14	16	18	20	22	24
	mm	40	50	65	80	100	125	150	200	250	300	350	400	450	500	550	600
H <sub>1</sub>		66	70	87	101	110	124	137	173	204	245	267	298	318	349	426	450
H <sub>2</sub>		105	149	165	164	180	205	219	252	283	332	368	400	422	479	525	562
L		33	43	46	46	52	56	56	60	68	78	77	85	104	130	143	151

- ★ Maximum Working Pressure : 16 Bar
- ★ End Flange Connection :  
**Universal Connection**  
(PN16/PN10/JIS10K /ANSI150)
- ★ >24" by Request

**16 BAR WAFER CHECK VALVE**

Wafer Type, Dual Plate

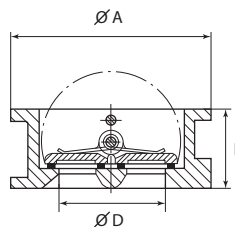
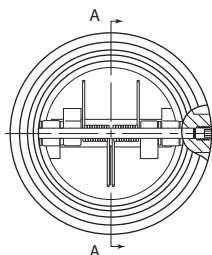

**Fig. PN16CW**

• Size : 1½" - 24"

**MATERIALS**

PART	MATERIAL
Body	Cast Iron
Disc	Ductile Iron
Stem	Stainless Steel 410
Seat	EPDM
Spring	Stainless Steel 304

Valve Size	inch	1½	2	2½	3	4	5	6	8	10	12	14	16	18	20	24
	mm	40	50	65	80	100	125	150	200	250	300	350	400	450	500	600
A		78	107	127	142	162	192	218	273	328	378	438	489	555	618	733
D		48	48	60	70	88	115	134	182	223	260	300	355	382	435	536
L		43	43	46	64	64	70	76	89	114	114	127	140	152	152	178

- ★ Maximum Working Pressure : 16 Bar
- ★ End Flange Connection :  
**Universal Connection**  
(PN16/PN10/JIS10K /ANSI150)
- ★ >24" by Request

20 BAR GATE VALVE

Rising Stem, OS & Y

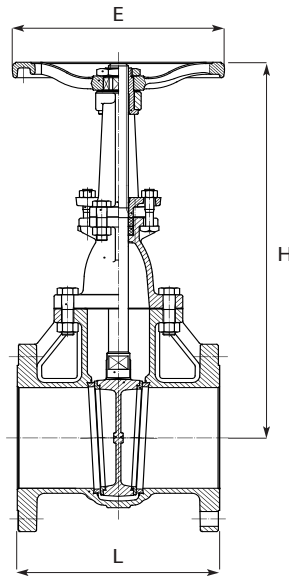

Fig. 150 DG

• Size : 2" - 12"

Valve Size	inch	2	2½	3	4	5	6	8	10	12
	mm	50	65	80	100	125	150	200	250	300
L Face-to-face		177.8	190	203	229	254	267	292	330.2	355.6
H Height (OPEN)		258	302	341	418	484	560	703	859	1021
E Handwheel Diameter		178	200	200	254	254	280	300	350	400

MATERIALS

PART	MATERIAL
Body	Ductile Iron
Stem	Stainless Steel
Bonnet	Ductile Iron
Handwheel	Cast Iron

- \* Maximum Working Pressure : 20 Bar
- \* End Flange Connection : ANSI B16.10
- \* Flange Drilled : ANSI B16.42
- \* >12" by Request

20 BAR SWING CHECK VALVE

Swing Type, Bolted Cover

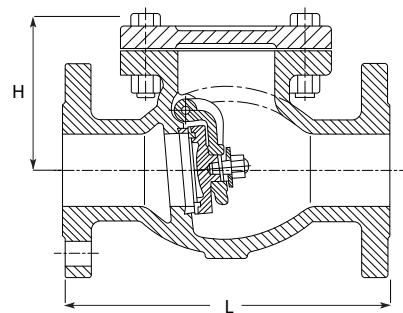

Fig. 150CC

• Size : 1½" - 24"

MATERIALS

PART	MATERIAL
Body	Cast Iron
Seat ring	Cast Bronze
Disc	Cast Iron
Bonnet	Cast Iron

- \* Maximum Working Pressure : 20 Bar
- \* End Flange Connection : ANSI B16.10
- \* Flange Drilled : ANSI B16.5
- \* >24" by Request

Valve Size	inch	1½	2	2½	3	4	5	6	8	10	12	14	16	18	20	22	24
	mm	40	50	65	80	100	125	150	200	250	300	350	400	450	500	550	600
L		203.2	203.2	215.9	241.3	292.1	330.2	355.6	495.3	622.3	698.5	787.4	914	914	1016	1219	
H		112	112	132	141	162	192	211	270	316	357	560	589	645	702	812	

**25 BAR GATE VALVE W.O.G**

Rising Stem, OS&Y

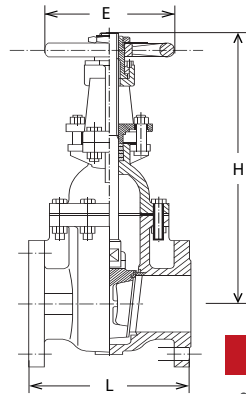

**Fig. N25CG**

• Size : 2" - 12"

Valve Size	inch	2	2½	3	4	5	6	8	10	12
	mm	50	65	80	100	125	150	200	250	300
<b>L Face-to-face</b>		215.9	241.3	282.5	304.8	381	403.2	419.1	457	502
<b>H Height (OPEN)</b>		385	437	493	611	716	813	1023.5	1211	1386
<b>E Handwheel Diameter</b>		175	200	254	300	300	348	400	457	457

MATERIALS

PART	MATERIAL
Handwheel	Cast Iron
Bonnet	Cast Iron
Body	Cast Iron
Stem	Brass
Wedge/Disc	Cast Iron
Seat Ring	Cast Bronze

- \* Maximum Working Pressure : 25 Bar
- \* End Flange Connection : PN 25
- \* >12" by Request

**25 BAR SWING CHECK VALVE W.O.G**

Swing Type, Bolted Cover

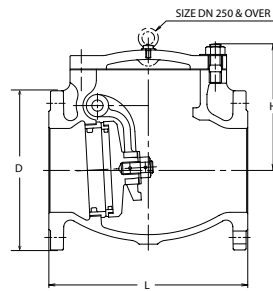

**Fig. N25CC**

• Size : 2" - 12"

Valve Size	inch	2	2½	3	4	5	6	8	10	12
	mm	50	65	80	100	125	150	200	250	300
<b>L</b>		267	292	318	356	400	444	533	622	711
<b>D</b>		165	191	210	254	279	318	381	445	521
<b>H</b>		135	150	166	190	206	244	291	337	383

MATERIALS

PART	MATERIAL
Body	Cast Iron
Cover / Bonnet	Cast Iron
Disc	Cast Iron
Seat Ring	Cast Bronze

- \* Maximum Working Pressure : 25 Bar
- \* End Flange Connection : PN 25
- \* >12" by Request

**25 BAR Y - PATTERN STRAINER W.O.G**

Bolted Cover

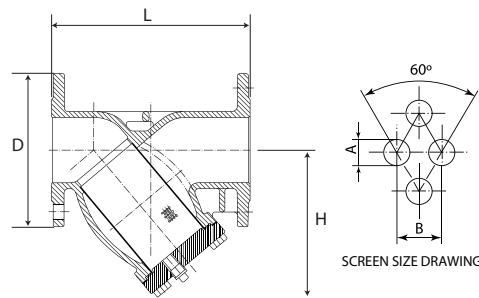

**Fig. N25DY**

• Size : 2½" - 12"

Valve Size	inch	2½	3	4	5	6	8	10	12
	mm	65	80	100	125	150	200	250	300
<b>L</b>		290	310	350	400	480	600	730	850
<b>D</b>		185	200	235	270	300	360	425	485
<b>H</b>		165	195	226	272	317	372	457	550

MATERIALS

PART	MATERIAL
Body	Ductile Iron
Cover	Ductile Iron
Screen	Stainless Steel (mesh 40)
Cover Bolt / Nut	Steel
Screw Plug	Stainless Steel

- \* Maximum Working Pressure : 25 Bar
- \* End Flange Connection : PN 25
- \* >12" by Request

\* Please consult to our sales for product sizes that are not listed in the brochure.